

3. Configuraciones sugeridas Suggested configurations

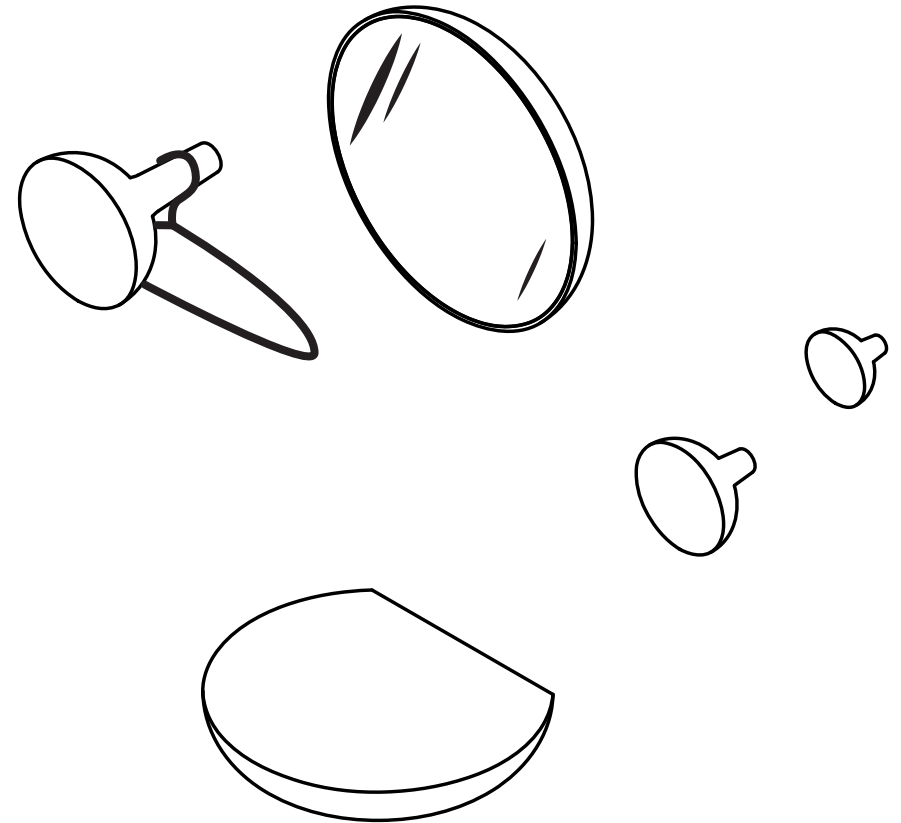

Diseña el recibidor a tu gusto
Design the entrance as you like

www.nomon.es

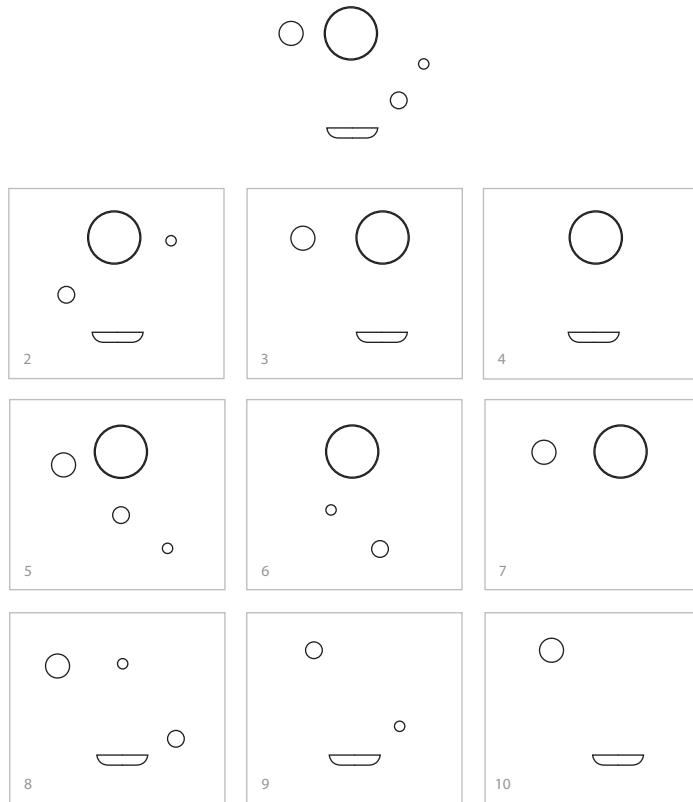

welcome

1. Instrucciones de montaje espejo y perchas S y M Assembly instructions for mirror and hangers S and M

Espejo / Mirror

1. Hacer agujero en la pared con broca M6.
Make the hole in the wall with M6 drill.

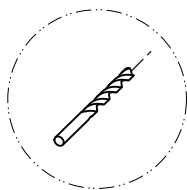

Broca / Drill M6

2. Introducir tornillo en el espejo/percha y taco en la pared.
Insert the screw into the mirror/hanger and the plug in the wall.

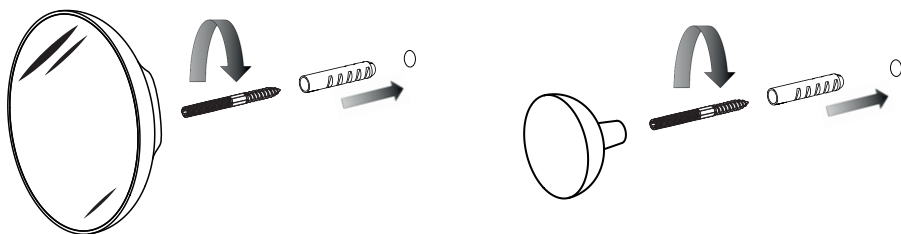

3. Roscar el espejo/percha en la pared.
Screw the mirror/hanger to the wall

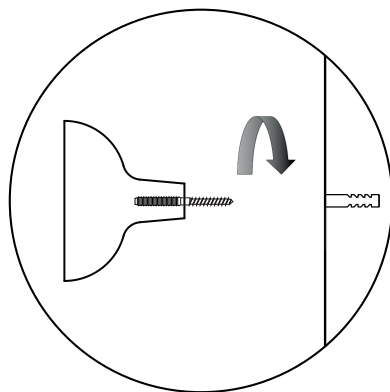
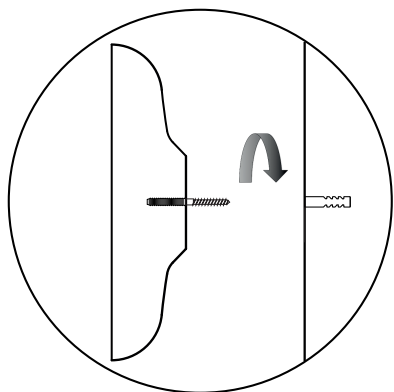

2. Instrucciones de montaje percha L y balda Assembly instructions for hanger L and shelf

Percha / Hanger L

1. Hacer agujero en la pared con broca M10 / Make the hole in the wall with M10 drill.
2. Introducir taco y tornillo en la pared / Insert the plug and the screw in the wall.

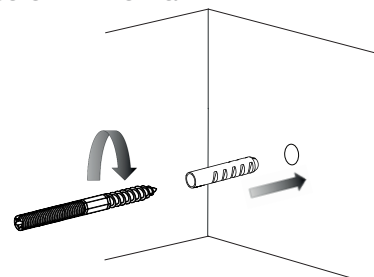

Atención! Caution!
Nunca roscar el tornillo directamente a la percha
Never thread the screw directly to the hanger

3. Roscar el tornillo en la pared con la ayuda de la llave. Una vez fijado en la pared roscar la percha.
Use the key tool to thread the screw to the wall then the hanger.

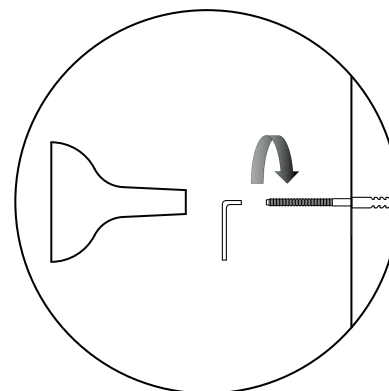

Balda / Shelf

1. Hacer agujeros en la pared con broca M6 / Make the holes in the wall with M6 drill.

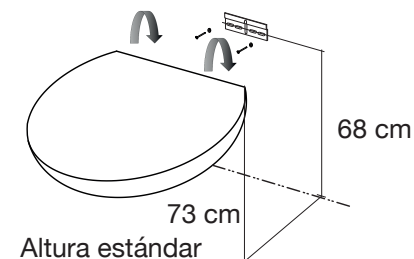

Altura estándar
Standard height

Atención! Caution!
Marcar los puntos en la pared antes de hacer los agujeros
Mark the spot on the wall before making the holes

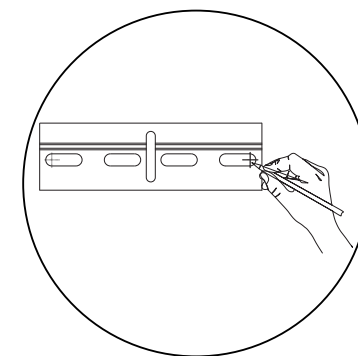

2. Una vez montada la fijación, colgar la balda mediante los ganchos que tiene en la parte posterior.
Once the fixture is attached to the wall, hang the shelf by the hooks on its back side.